



Reference Image

ELEVATE YOUR LIFESTYLE

Framed by endless views, wake up to enchanting panoramas of the city skyline.

Designed with choice amenities to redefine the routine, Auris Bliss captures the wonder of every day that soars above the rest. Towering into the skies, uncover the life extraordinaire.



Reference Image

EXPANSIVE RESIDENCES,
ENDLESS VIEWS



Reference Image

40+ LEVELS OF
UNPARALLELED LIFESTYLE



Reference Image

IN THE VICINITY
OF PREMIER BRANDS
Social, Retail

YOUR WORLD COMES CLOSER



Transcon
Art of Transforming

Auris Bliss, Next to Agrawal B2B Centre, Opp. Vasant View, De Monte Lane, Kanchpada, Malad (W), Mumbai - 400 064

Disclaimer: The plans, specification, elevation, conceptual designs, visuals, images, dimensions, photograph, furniture, fixtures, amenities, facilities etc., are strictly provided for representation purpose only and are subject to requisite approvals from the competent authorities unless otherwise stated herein. This does not constitute an offer and/or contract of any nature between the company and the prospective purchaser/customers has independently satisfied himself before any conclusive decision. All brand names and trademarks stands reserved. Stamp duty and Registration applicable on booking.



Principal Leader



SHETH CREATORS
Envisioning Landmarks

MAHARERA NO. P51800000970
For more information, please visit
maharera.mahaonline.gov.in



Transcon
Art of Transforming



SHETH CREATORS
Envisioning Landmarks

AURIS BLISS

LINK ROAD, MALAD WEST

LIVE

Thoughtfully
Designed
2BHK
Residences



Reference Image with Actual View



Reference Image

EXPERIENCE
BLISS
EVERY DAY

20+ Amenities
Across 3 Zones

PLAY



Reference Image

WORK

A Neighbourhood
of Achievers



Reference Image

AT THE INTERSECTION
OF EXPERIENCES



REVEL

- 1. Lobby
- 2. Pool Water Jets
- 3. Water Cascade
- 4. Alfresco Deck
- 5. Canopy Deck
- 6. Pool Deck
- 7. Barbecue Counter
- 8. Party Lawn
- 9. Seating Deck
- 10. Paved Plaza
- 11. Multi-Purpose Hall
- 12. Indoor Games Room

REJUVANATE

- 13. Swimming Pool
- 14. Bubble Pool
- 15. Palm Grove
- 16. Walkway
- 17. Aroma Walkway
- 18. Gymnasium
- 19. Open-Air Gym
- 20. Reflexology Pathway

REJOICE

- 21. Kids' Pool
- 22. Kids' Play Area
- 23. Tot Lot
- 24. Skating Area

PROJECT
AMENITIES

- CCTV in the Common Area
- High Speed Passenger Elevators
- State-of-the-Art Firefighting Equipment
- Provision of Piped Gas Connection
- STP Plant, Rainwater Harvesting
- Grand Entrance Lobby

SPACES PLANNED FOR
SEAMLESS EXPERIENCES

TYPICAL FLOOR PLAN
30th to 32nd , 36th to 40th Floor

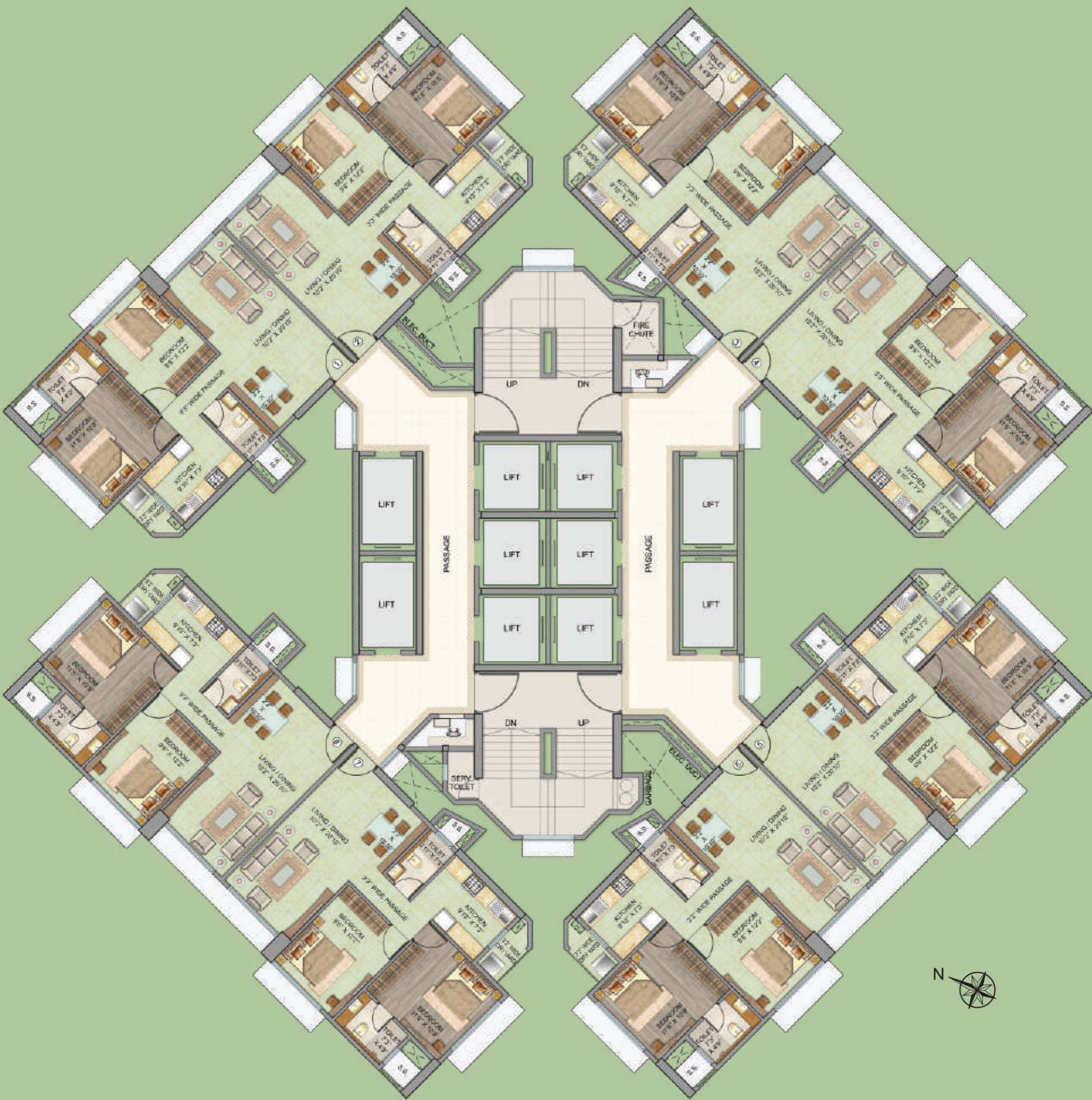

AREAS STATEMENT			
FLAT NO.	TYPE	RERA CARPET AREA (in sq.ft.)	DRY YARD (in sq.ft.)
1	2 BHK	659.50	17
2	2 BHK	659.50	17
3	2 BHK	659.50	17
4	2 BHK	659.50	17
5	2 BHK	659.50	17
6	2 BHK	659.50	17
7	2 BHK	659.50	17

HOMES OPTIMIZED FOR
THE COMPLETE LIFE

2 BHK UNIT PLAN
30th to 40th Floor



RERA Carpet Area: 659.50 sq.ft.
Deck Area: 17 sq.ft.

INTERNAL AMENITIES

- Premium quality door & door frames
- Aluminum window with powder coating
- Vitrified flooring in the living, dining, & bedroom
- Bathroom flooring: good quality vitrified tiles
- Finished bathrooms with Jaguar/Kohler or equivalent sanitary ware fittings
- Kitchen adorned with vitrified tiles flooring & dado
- Granite counters with S.S.sink in the kitchen
- Provisions for telephone, lights, fans & TV points with adequate extra points, D2H & Internet (Wi-Fi)
- DG power back-up for designated areas of apartments/elevators and common areas
- Panic button in the living and master bedroom
- Gas leak detector in the kitchen